

MEETING MINUTES

Project	Roosevelt High School	Project No	PPS:ARCH 60117, BA: 13910
Subject	Design Advisory Group (DAG) #9	Meeting Date	1/16/2014
From	Glen Pak, Bassetti	Date	1/22/2014

Attending

Glen Pak	Bassetti	Nate Buddress	Lease Crutcher Lewis
Joe Echeverri	Bassetti	Greg Neuman	RHS DAG/Vice Principal
Lorne McConachie	Bassetti	Mike Verbout	RHS DAG
Michelle Platter	PPS OSM	Kelsey Green	RHS DAG
Sarah Oaks	PPS OSM	Jo Lane	RHS DAG
Kimm Fox Middleton	PPS Communications	Catherine Theriault	RHS DAG
Dennis Phillips	Community Member	Jason Starman	RHS DAG
		Jenni Villano	RHS DAG

Discussion:

1. Michelle spoke about the milestone schedule for the project. The project is currently in Schematic Design phase.
2. The CMGC has been selected and the contract awarded to Lease Crutcher Lewis.
3. Michelle said a new position called an Educational Liaison will be brought on board to help facilitate teacher and staff coordination.
4. It was agreed that more student representation is needed at the DAG meetings. The DAG will make recommendations for two students who will be present at the next DAG meeting.
5. Future DAG meetings will remain at Roosevelt but other meetings like community meetings may be held at different locations such as feeder schools.
6. Bassetti presented an Enhanced Electives presentation, which is attached to the end of these meeting minutes.
 - a. The direction of the Enhanced Electives was approved by the DAG.
 - b. Dennis Phillips would like to know what is being programmed in the Enhanced Electives spaces. Bassetti to develop these spaces during Schematic Design and look at different options to ensure the spaces can be flexible to teach a number of different curriculum.
 - c. A culinary element would contain a light demonstration kitchen.
 - d. The separation of 6000 square feet of Enhanced Electives would be according to the need of the space. For example, the Makers Lab would be larger than the Small Business Lab.

END OF MEETING 01.16.14 MINUTES

Next Meeting: 01/30/14

MEETING MINUTES

Page 2 of 2

Roosevelt High School
Design Advisory Group (DAG) #9
1/16/2014

Attachments: Enhanced Electives Presentation

Meeting minutes composed by: Glen Pak, Bassetti Architects

Bassetti Architects believes these meeting minutes accurately convey the discussions and decisions that occurred during the meeting. These minutes will become part of the project record unless comments pertaining to the accuracy of these minutes are received from attendees within 5 calendar days of issuance of minutes.



STEM Lab

- Engineering
- Environmental Science
- Robotics
- Aeronautics
- Biotechnology
- Architecture & CAD
- Computer Science

STEM Lab Infrastructure

- Overhead, flexible electrical and data wiring
- 1-phase and 3-phase electrical outlets
- Water supply
- Floor drains

STEM Lab Specialty Equipment

- 3D Printer
- Computers
- Small hoisting mechanism



Science Lab



Vashon Island High School
Integrus Architecture



Vashon Island High School
Integrus Architecture

STEM Adjacencies

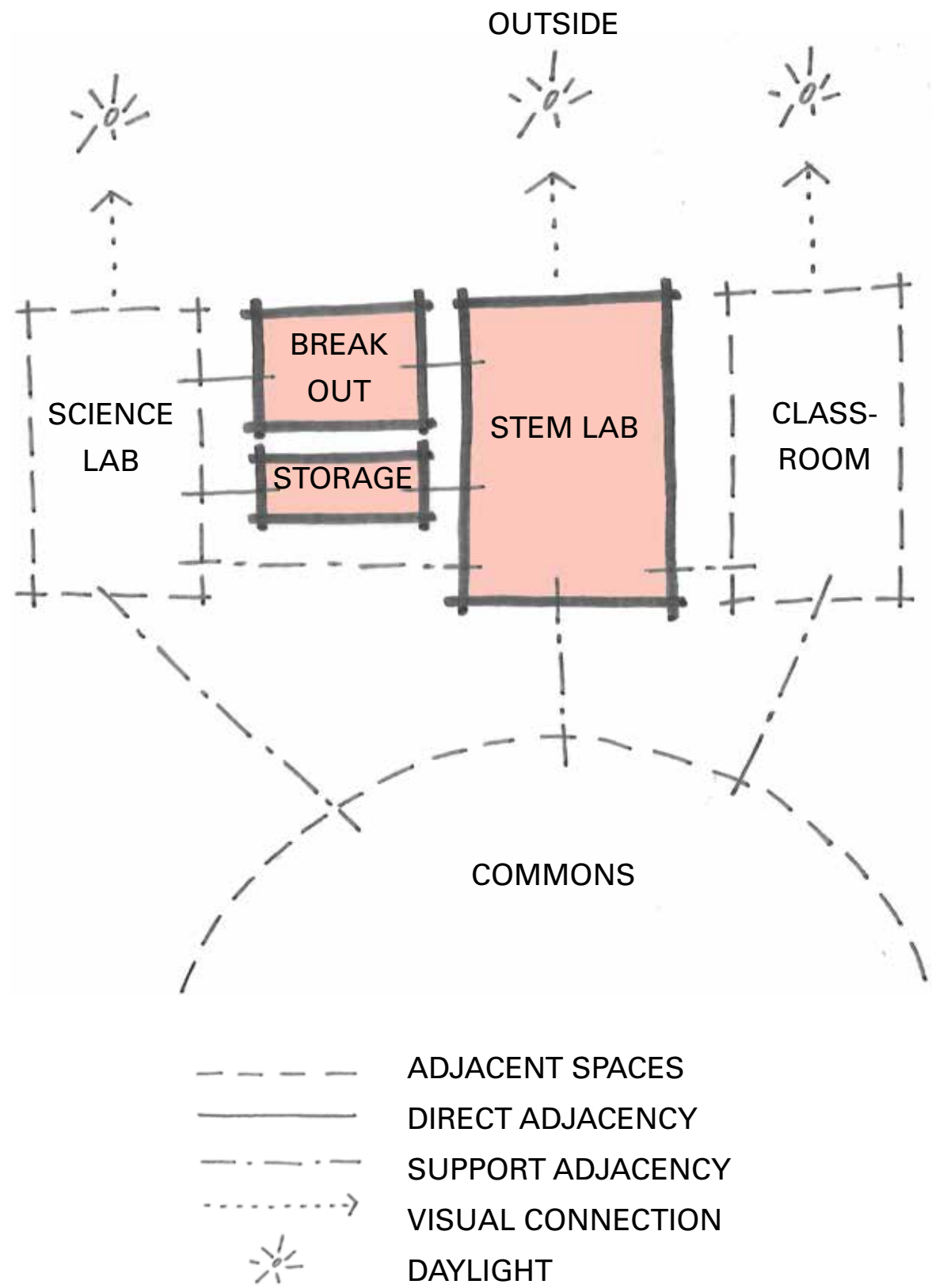

Classroom



Break Out



Internet image



Makers Lab

- Arts, Education & Recreation
- Wood & Metal Arts
- Performing Arts
- Graphic & Visual Arts
- Cultural Arts
- Stage Design & Construction

Makers Lab Infrastructure

- Overhead, flexible electrical and data wiring
- 1-phase and 3-phase electrical outlets
- Dust collection and exhaust
- Water supply
- Garage door to exterior

Makers Lab Specialty Equipment

- Power tools (Bandsaw, lathe, drillpress, etc.)
- Hand tools
- Computer controlled (C&C router, laser cutter)



Theater Back-of-House



Theater



Art Classroom



Makers Lab Adjacencies

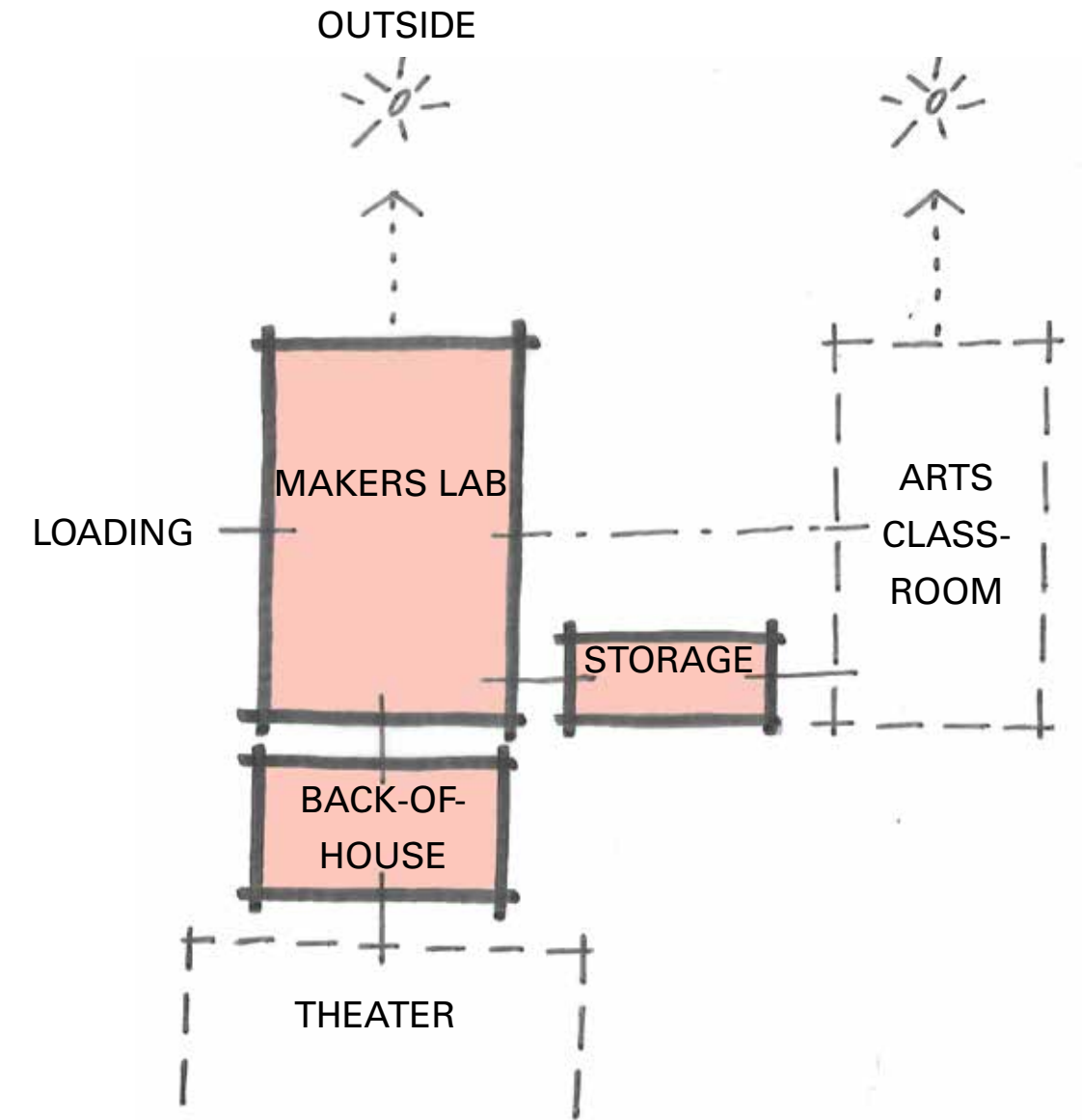

- ADJACENT SPACES
- DIRECT ADJACENCY
- . - SUPPORT ADJACENCY
- ...-> VISUAL CONNECTION
- ☀ DAYLIGHT

Publishers Lab



Internet image



Internet image

Publishers Lab

- Social Justice
- Writing and Publishing
- Law and Justice
- Education
- Social Services

Publishers Lab Infrastructure

- Flexible electrical and data wiring
- Presentation space

Publishers Lab Specialty Equipment

- Large format printer
- Mat cutters
- Small booklet binding equipment
- Computers

Writers Lab



Library





Publishers Lab Adjacencies

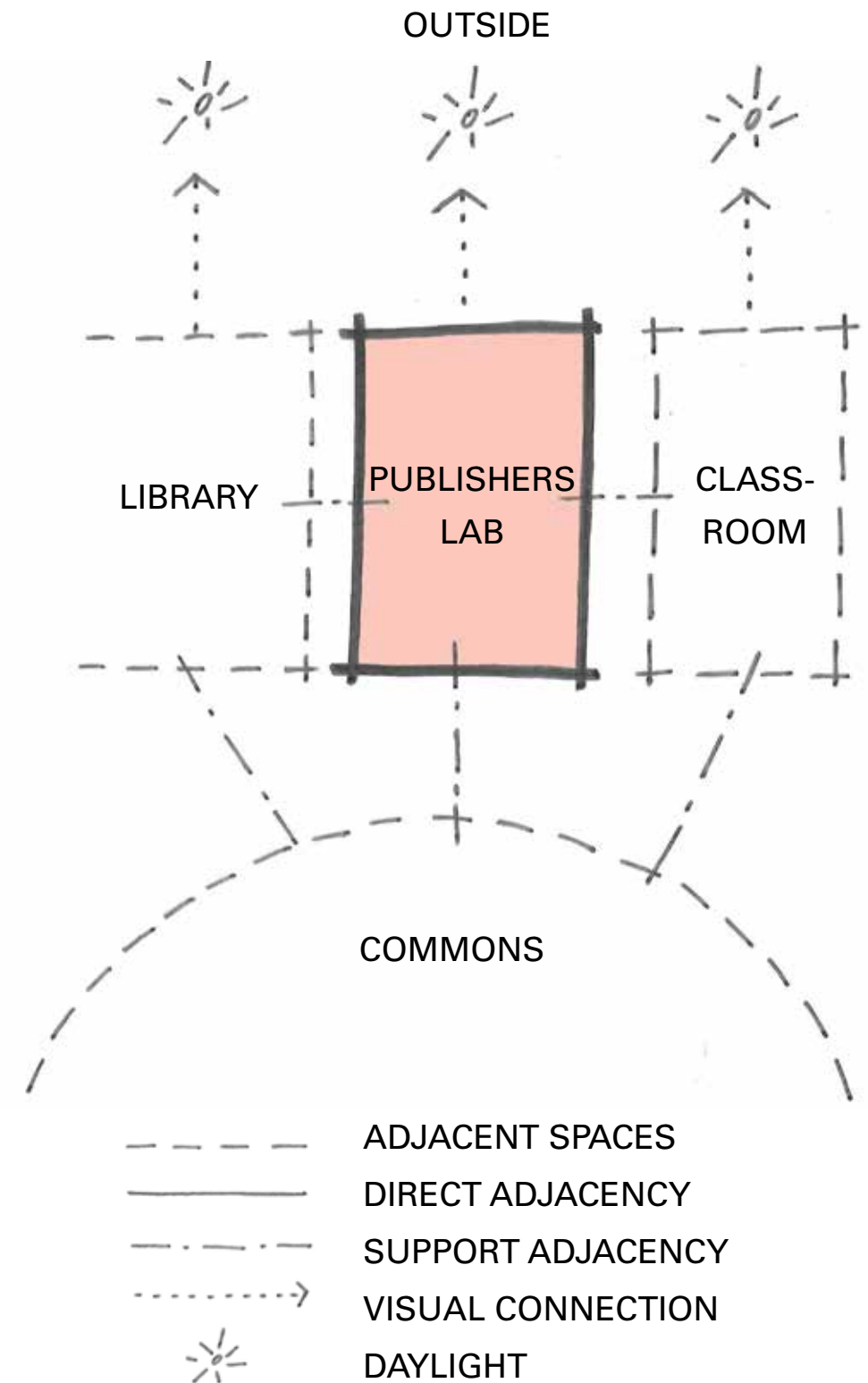

Small Business Lab



Internet image

Small Business Lab

- Hospitality
- Cooking
- Nutrition
- Finance
- Business Management
- Marketing
- Advertising
- Real Estate

Small Business Lab Infrastructure

- Flexible electrical wiring
- 1-phase and 3-phase electrical outlets
- Water supply (optional)

Small Business Lab Specialty Equipment

- Light demonstration kitchen



Student Store



Internet image

Student Store



Small Business Lab Adjacencies

OUTSIDE

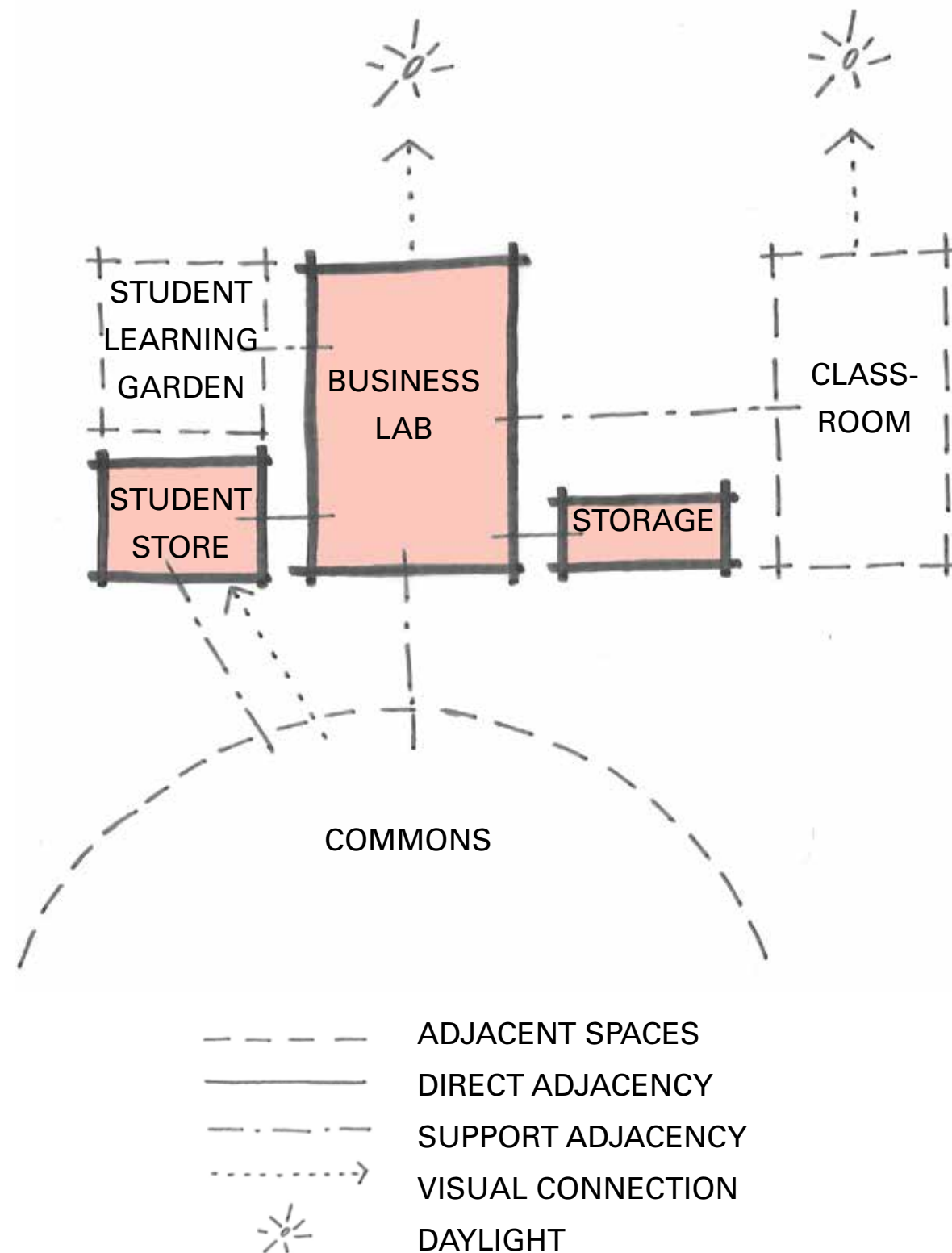

Classroom



Student Learning Garden



Internet image

**Roosevelt High School
Milestone Schedule
01/14/14**

COO – Chief Operations Officer OSM – Office of School Modernization DAG – Design Advisory Group RHS – Roosevelt High School
--

This schedule is conceptual only and is subject to change both in content and dates.

Early June 2013
14 June 2013
Late July 2013
19 September 2013
21 September 2013
3 October 2013
10 October 2013
16 October 2013
17 October 2013
19 October 2013
October 23, 2013
6 November 2013
12 November 2013
19 November 2013
2 December 2013
9 December 2013
November – February 2014

DAG Committee
MILESTONE
School Board
DAG/RHS Staff/Public
DAG/RHS Staff/Public
DAG/RHS Staff/Public
RHS Staff
RHS Staff/Public
DAG/RHS/Public
DAG/RHS Staff/Public
RHS Students
DAG/RHS/Public
MILESTONE
DAG/RHS Staff/Public
MILESTONE
MILESTONE
DAG/Staff/Public

First Meeting (Topics/Frequency/Communication)
Last Day of School
Architect Recommendation/Approval
DAG Meeting #5 – Planning
Design Workshop MP#1 – Planning
DAG Meeting #6 – Planning
Teacher input Meeting #1
Teacher Update and PTSA
DAG Meeting #7 - Planning
Design Workshop MP#2 – Planning
Student Engagement in Classrooms
DAG Meeting #8 – Master Plan Review
Board Meeting – School Capacity Review
Master Planning Open House
Master Plan Complete/Board Review
Master Plan Complete/Board Approval
Community/Staff Input – Design Concepts

January 21 2014	School Board	General Contractor Recommendation/Approval
January – March 2014	DAG/Staff/Public	Schematic Design Coordination
April 2014	MILESTONE	Schematic Design Complete/Board Approval
April – November 2014	DAG/Staff Public	Community Engagement - Design Presentations
May 2014	RHS Staff/Students	“Construction Phasing & What to Expect”
December 2014	MILESTONE	Construction Documents Phase 1 Complete
December 2014	Project Team/Students/Staff	Construction Presentation “What to Expect”
January 2015	General Contractor	Site Mobilization/Early Construction Activities
1 st Quarter 2015	MILESTONE	Ground Breaking Ceremony
Spring 2015	MILESTONE	Building Permits/Construction
Early June, 2015	Staff/Students	Update before Summer break
2 nd Qtr 2015 – 4th Qtr 2016	Public Construction Tour(s)	(may consider more than one as time/schedule allow)
Early June, 2016	Staff/Students	Update before Summer break
4 th Quarter 2016	All RHS Staff	90% Completion Tour
1 st Quarter 2017	MILESTONE	Construction Complete
Start of 2nd Qtr 2017	All RHS Staff	Furniture Pre-installation Walk-through
2 nd Quarter 2017	PPS	FF&E/Move-in
September 2017	MILESTONE	Start of School in New Facility

*Weekly meetings are being held with Administrative Staff at RHS until further notice.